

Fire barrier foam



Usage

Installation examples

- High-efficiency thermal insulation on facades
- Sealing window frame gaps and around window sills
- Filling of cavities in walls and ceilings

Description

- Hardly flammable, single-component polyurethane foam.
- The foam hardens as a reaction to atmospheric humidity.

Examples of use

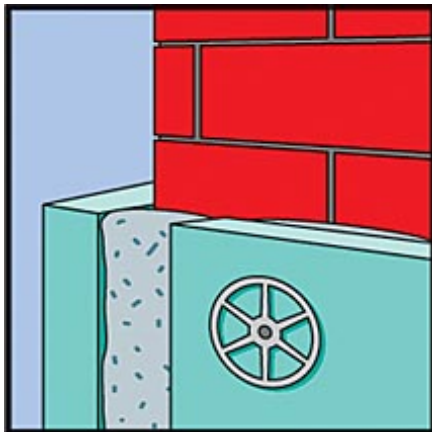





Installation

Installation information

- General test certificate from building authorities: P-NDS 04-386
- Hardly flammable B1 as per DIN 4102 Part 1.
- Grey coloured to differentiate from standard foam.
- Wet base surface if atmospheric humidity is low.
- Shake cartridge before use.
- Extrude with PU pistols (refer to page XY).
- Foam yield of extruded foam: up to 45 litres.
- Resistance to temperature of hardened foam: -30° C to +80° C.
- Non-tacky after approx. 10 minutes, can be cut after approx. 25 minutes, load-bearing after approx. 3 hours, completely hardened after approx 5 - 8 hours (all details based on temperature of +20° C).

Technical data

Type	Art.-No.	ETA  DIBt 	contents per canister [ml]	max. foam yield (free foaming) [l]	shelf life months	languages on the label		EAN Code	ID	qty. per box pcs.
PUFS 750	45300	-	750	45	12	D	39095090	4006209453001	1	12